

Signaling units

Harmony[®] XVS sirens and electronic alarms

Catalog

September **2013**



How to find the “Automation and Control” products

> Catalogs

Complete product ranges



> Essential guides

Selection of the top selling products

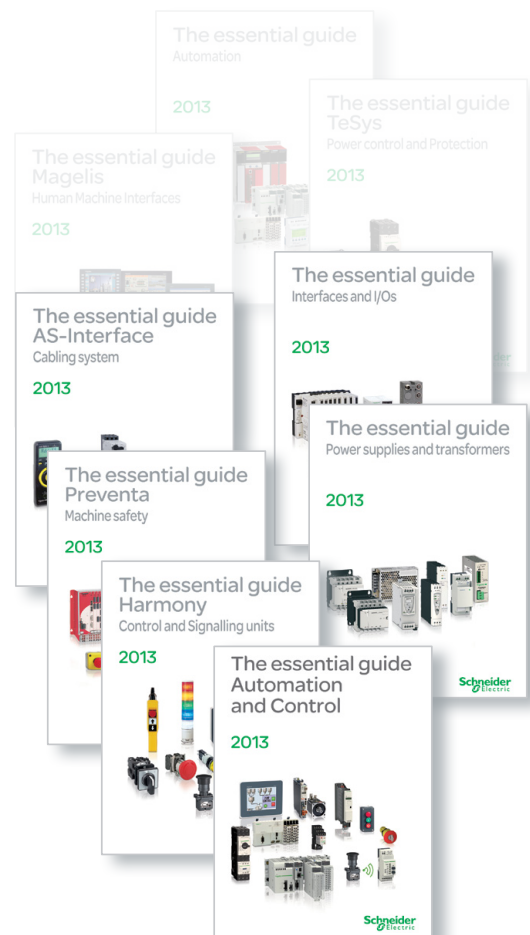

General contents

Harmony® XVS sirens and electronic alarms

Selection guide page 2

■ Presentation

□ Sound units Harmony® type XVS page 6

■ References

□ Sirens and electronic alarms page 7

■ How to find the “Automation and Control” products

□ Search, visualize, and download page 8

□ Access product references with adapted tools page 10

□ Compare, select, and compile page 12

□ Check the product status, design your equipment page 13

■ **Product reference index** page 14

Harmony® type XV **Monolithic tower lights**



Type of products	Complete pre-cabled pilot lights, height 55 mm/2.17 in.	Complete miniature beacons	Pre-assembled/pre-cabled tower lights Variable composition tower lights for customer assembly of up to 4 units
Diameter	Ø 25 mm/0.98 in.	Ø 45 mm/1.75 in.	Ø 60 mm/2.36 in.
Degree of protection conforming to IEC 60529	IP 40	IP 40	IP 53 and IP 42 (base mounting) IP 23 (direct aluminium tube mounting, aluminium tube mounting and "L" bracket) IP 53 and IP 42 (aluminium tube mounting and fixing plate) IP 40 (aluminium tube mounting and foldable bracket)
Type of signalling	Steady Flashing "Flash" Sound	Yes – Yes –	Yes – – With buzzer
Light sources	Incandescent bulb LED bulb Integral LED "Flash" discharge tube Halogen bulb	Yes – – Yes –	– – Yes – –
Colors of illuminated units	<input type="checkbox"/> Green <input type="checkbox"/> Red <input type="checkbox"/> Clear <input type="checkbox"/> Yellow	<input type="checkbox"/> Green <input type="checkbox"/> Red <input type="checkbox"/> Orange <input type="checkbox"/> Blue <input type="checkbox"/> Clear <input type="checkbox"/> Yellow	<input type="checkbox"/> Red <input type="checkbox"/> Green <input type="checkbox"/> Amber <input type="checkbox"/> Blue
Connection	Flying leads, length 360 mm/14.17 in.	Screw clamp terminals	Flying leads, length 500 to 560 mm/19.68 to 22.05 in. for tube mounting according to model. Length 900 mm/35.43 in. for base mounting.
Support panel drilling or cut-out	Ø 22 mm/0.87 in. or Ø 30 mm/1.18 in.	3 x Ø 3.3 mm/0.13 in. or M3	Base mounting: 3 x Ø 5 mm/0.20 in. Direct aluminium tube mounting: Ø 20/0.79 in. Aluminium tube mounting and "L" bracket: 2 x Ø 9/0.35 in. Aluminium tube mounting and fixing plate: 4 x Ø 6/0.24 in. Aluminium tube mounting and foldable bracket: 4 x Ø 6/0.24 in.
Type references	XV1CA	XVDLS	XVG



Type of products	Pre-assembled and pre-cabled tower lights	Pre-assembled and pre-cabled tower lights	Pre-assembled and pre-cabled tower lights	Pre-assembled and pre-cabled USB tower lights
Diameter	Ø 40 mm/1.57 in.	Ø 60 mm/2.36 in.	Ø 100 mm/3.94 in.	Ø 60 mm/2.36 in.
Degree of protection conforming to IEC 60529	IP 54 (flat surface installation) IP 23 (vertical surface installation)	IP 54 (flat surface installation) IP 23 (vertical surface installation)	IP 54 (flat surface installation)	IP 42
Type of signalling	Yes Yes – With buzzer – – Yes – –	Yes Yes – With buzzer – – Yes – –	Yes Yes – With siren or buzzer – – Yes – –	Yes Yes – With buzzer (volume control and alarm type can be set with HMI) – – Yes – –
Light sources	– – – – – –	– – – – – –	– – – – – –	– – – – – –
Colors of illuminated units	<input type="checkbox"/> Red <input type="checkbox"/> Orange <input type="checkbox"/> Green <input type="checkbox"/> Blue <input type="checkbox"/> Clear	<input type="checkbox"/> Red <input type="checkbox"/> Orange <input type="checkbox"/> Green <input type="checkbox"/> Blue <input type="checkbox"/> Clear	<input type="checkbox"/> Red <input type="checkbox"/> Orange <input type="checkbox"/> Green <input type="checkbox"/> Blue <input type="checkbox"/> Clear	Multi-color LEDs (many possible combinations can be set with HMI) <input type="checkbox"/> Red <input type="checkbox"/> Orange <input type="checkbox"/> Green <input type="checkbox"/> Blue
Connection	Flying leads, length 450 mm/17.71 in. to 900 mm/35.43 in. according to model	Flying leads, length 450 mm/17.71 in. to 850 mm/33.46 in. according to model	Flying leads, length 500 mm/19.68 in.	USB power cable: - 300 mm/11.81 in. for tube mounting - 400 mm/15.75 in. for direct mounting
Support panel drilling or cut-out	Mounting on support tube with bracket: 2 x Ø 9 mm/0.35 in. Direct mounting on horizontal support: 3 x Ø 5 mm/0.20 in. Other mounting possibilities with accessories	Mounting on support tube with bracket: 2 x Ø 11 mm/0.43 in. Direct mounting on horizontal support: 3 x Ø 5 mm/0.20 in. Other mounting possibilities with accessories	Direct mounting on horizontal support: - 3 x Ø 6 mm/0.24 in. (without siren) - 3 x Ø 7 mm/0.28 in. (with siren) Other mounting possibilities with accessories	Mounting on support tube with fixing plate: 4 x Ø 6 mm/0.24 in. Direct mounting on horizontal support: 3 x Ø 5 mm/0.20 in.
Type references	XVC4	XVC6	XVC1	XVGU

Harmony® type XV		Modular tower lights	
			
Type of products	Pre-assembled/pre-cabled tower lights Variable composition tower lights for customer assembly of up to 5 units	Tower lights for customer assembly of up to 5 units.	
Diameter	Ø 45 mm/1.77 in.	Ø 60 mm/2.36 in.	
Degree of protection conforming to IEC 60529	IP 54 in vertical position (XVM with plastic fixing plate) IP 42 in horizontal position (XVM with metal bracket) IP 40 in other positions (all types of XVM tower lights)	IP 65 for illuminated units IP 54 for audible units IP 55 for flexible mounting option	
Type of signalling	Steady Flashing "Flash" Sound	Yes Yes Yes Yes	Yes Yes Yes Yes
Light sources	Incandescent bulb LED bulb Integral LED "Flash" discharge tube Halogen bulb	Yes Yes - Yes -	- - Yes - -
Colors of illuminated units	<input type="checkbox"/> Red <input type="checkbox"/> Green <input type="checkbox"/> Orange <input type="checkbox"/> Blue <input type="checkbox"/> Clear	<input type="checkbox"/> Green <input type="checkbox"/> Red <input type="checkbox"/> Orange <input type="checkbox"/> Blue <input type="checkbox"/> White <input type="checkbox"/> Yellow (only for multi-color unit with above colors)	
Connection	Flying leads, length 300 mm/11.81 in. or screw terminals	Spring cage connection terminals	
Support panel drilling or cut-out	Mounting on bracket: 2 x Ø 9 mm /0.35 in. Mounting on support tube: 4 x Ø 5.5 mm/0.22 in. or M5	Mounting on support tube and adjustable support tube: 4 x Ø 6 mm/0.24 in. Direct mounting and Flexible wall mounting: 3 x Ø 5 mm/0.196 in.	
Type references	XVM	XVU	

		Rotating beacons	Sound solutions
			
Type of products	Illuminated beacons Variable composition tower lights for customer assembly of up to 5 units	Pre-cabled rotating beacons	Sirens and electronic alarms
Diameter	Ø 70 mm/2.76 in.	Ø 84 mm/3.31 in. to Ø 130 mm/5.12 in.	-
Degree of protection conforming to IEC 60529	IP 65 (mounted on fixing base XVBZ0●) IP 66 (mounted on base unit)	Ø 84 mm/3.31 in. and Ø 106 mm/4.17 in.: IP 23 (IP 65 with accessory) Ø 120 mm/4.72 in.: IP 23 Ø 130 mm/5.12 in.: IP 66 and IP 67 (depending on voltage)	IP 53 (sirens) IP 54 (electronic alarms)
Type of signalling	Yes Yes Yes Yes Yes	Yes - - Yes -	- - - Yes -
Light sources	Yes "PROTECTED LED" "PROTECTED LED" Yes -	- "Super Bright" - - Yes	- - - - -
Colors of illuminated units	<input type="checkbox"/> Green <input type="checkbox"/> Red <input type="checkbox"/> Orange <input type="checkbox"/> Blue <input type="checkbox"/> Clear <input type="checkbox"/> Yellow	<input type="checkbox"/> Red <input type="checkbox"/> Orange <input type="checkbox"/> Green <input type="checkbox"/> Blue	-
Connection	Screw clamp terminals	Flying leads, length 400 mm/15.75 in.(except XVR08: 500 mm/19.68 in.)	Screw clamp terminals (except XVS14: flying leads, length 500 mm/19.68 in.)
Support panel drilling or cut-out	Mounting on support tube: 4 x Ø 5.5 mm/0.22 in. or M5 Vertical mounting: 3 x Ø 5 mm/0.20 in. or M5 Direct mounting: 2 x Ø 4.5 mm/0.18 in. or M4	Depending on model: - XVR08 (Ø 84 mm/3.31 in.): 3 x Ø 5 mm/0.20 in. - XVR10 (Ø 106 mm/5.12 in.): 3 x Ø 5 mm/0.20 in. - XVR12 (Ø 120 mm/4.72 in.): 3 x Ø 6 mm/0.24 in. - XVR13 (Ø 130 mm/5.12 in.): 3 x Ø 9 mm/0.35 in. - XVR13●●L (Ø 130 mm/5.12 in.): 3 x Ø 7 mm/0.28 in.	3 x Ø 6.5 mm/0.25 in.
Type references	XVBL, XVBC	XVR	XVS

Signaling Units

Sound units Harmony® type XVS

Sirens and electronic alarms



XVS10●M

Presentation

The sirens and electronic alarms in the Harmony® XVS range are audible signaling units used for long distance indication of the operating status or sequences of a machine or installation. They are mainly used on conveyor belts, on automated industrial trucks and on the doors of electrical control panels.

The range involves several types of ready to use products:

- sirens with 2 tones, with very compact size, type XVS10,
- multisound sirens (43 tones), pre-cabled, 8 channels, type XVS14,
- electronic alarms, white or black color, 16 tones, 4 channels, type XVS72 and XVS96, to be mounted on panels (protection: IP 54).

The sound, with continuous or intermittent tone:

- guarantees a sound level of 106 dB at 1 m for XVS10,
- can be adjusted from 0 to 105 dB at 1 m for XVS14,
- can be adjusted from 0 to 90 dB at 1 m for XVS72,
- can be adjusted from 0 to 96 dB at 1 m for XVS96.

Environment

The XVS sirens and electronic alarms offer the following degrees of protection:

- IP 53 for sirens type XVS10 and XVS14,
- IP 54 for electronic alarms type XVS72 and XVS96.

These products meet the requirements of the following standards:

- EN/IEC 61000-6-2 and EN/IEC 61000-6-3 for voltages 120 V and 230 V A.C. (XVS14BMW and XVS72),
- EN/IEC 60947-1 and EN/IEC 60947-5-1 for voltages 12 V and 24 V A.C. (XVS10, XVS14GMW and MMW and XVS96).

They are CE, UL and CSA certified.

Connection

Products are to be connected:

- through cable-glands for using 6.5 mm to 8.5 mm cables (XVS10)
- through power wire c.s.a.: 0.52 mm² and signal wire c.s.a.: 0.33 mm², with flying leads, length 500 mm (XVS14),
- through screw clamp terminals (XVS72 and XVS96).

For more technical information, please refer to our website www.schneider-electric.com.

Signaling Units

Sound units Harmony® type XVS
Sirens and electronic alarms



PF560816

XVS10●M



PF560825

XVS14●MW



PF560826

XVS72BM●●



PF560827

XVS96BM●●

References				
Description	Voltage	Color	Reference	Weight
	V			kg
Sirens 106 dB, 2 tones	~ 12-24	White	XVS10BMW	0.800
	~ 120	White	XVS10GMW	1.000
	~ 230	White	XVS10MMW	1.000
Multisound sirens 0 to 105 dB, 43 tones 8 channels Pre-wired	~ 12/24	White	XVS14BMW	1.000
	~ 120	White	XVS14GMW	1.200
	~ 240	White	XVS14MMW	1.200
Electronic alarms 0 to 90 dB, 16 tones Panel Mount DIN72 4 channels	~ 12/24	PNP, Black	XVS72BMBP	0.180
		PNP, White	XVS72BMWP	0.180
	~ 12/24	NPN, Black	XVS72BMBN	0.180
		NPN, White	XVS72BMWN	0.180
Electronic alarms 0 to 96 dB, 16 tones Panel Mount DIN96 4 channels	~ 12/24	PNP, Black	XVS96BMBP	0.400
		PNP, White	XVS96BMWP	0.400
	~ 12/24	NPN, Black	XVS96BMBN	0.400
		NPN, White	XVS96BMWN	0.400

Search, visualize, and download

Use your tablet or your PC to quickly access detailed and comprehensive information on our products



Tablets

Application name: "Automation Library by Schneider Electric"

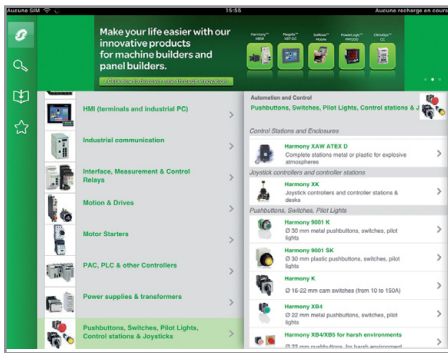

Product ranges displayed by function

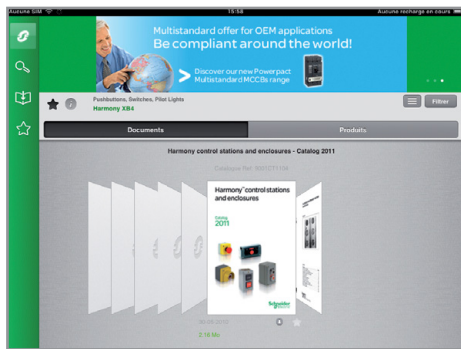
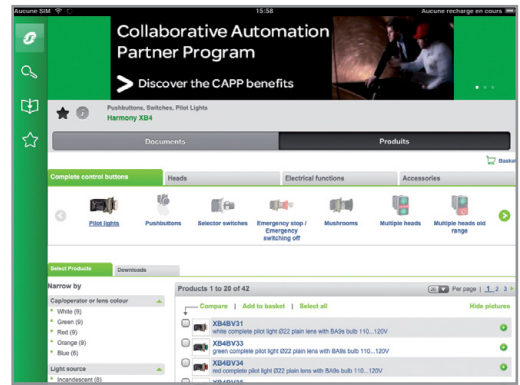

Dynamic catalogs (hyperlinks, video, ...)

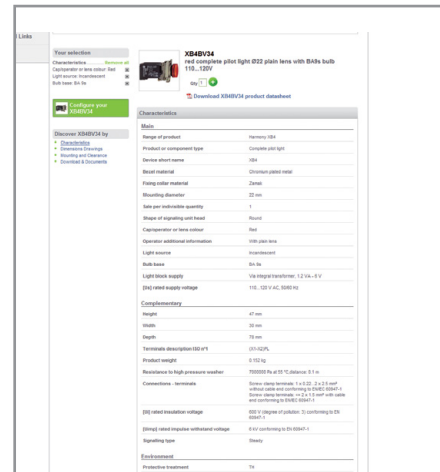

Product selector: dynamic filters to get easily your part number



Personal computer

Path: www.schneider-electric.com > **Products and Services** > Automation and control > Product offer

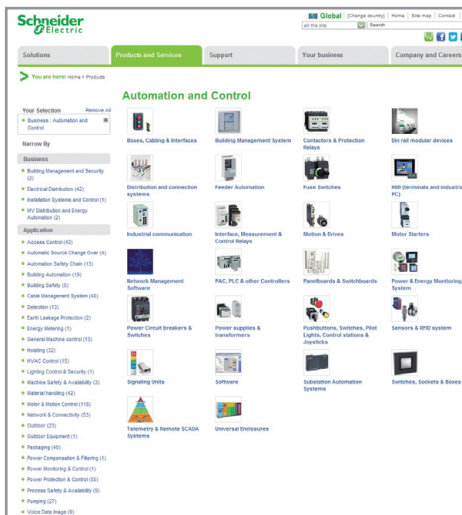

Product ranges displayed by function

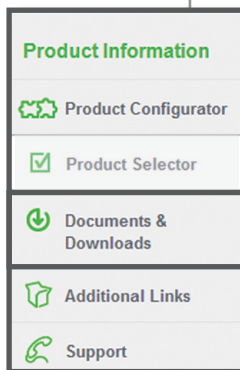
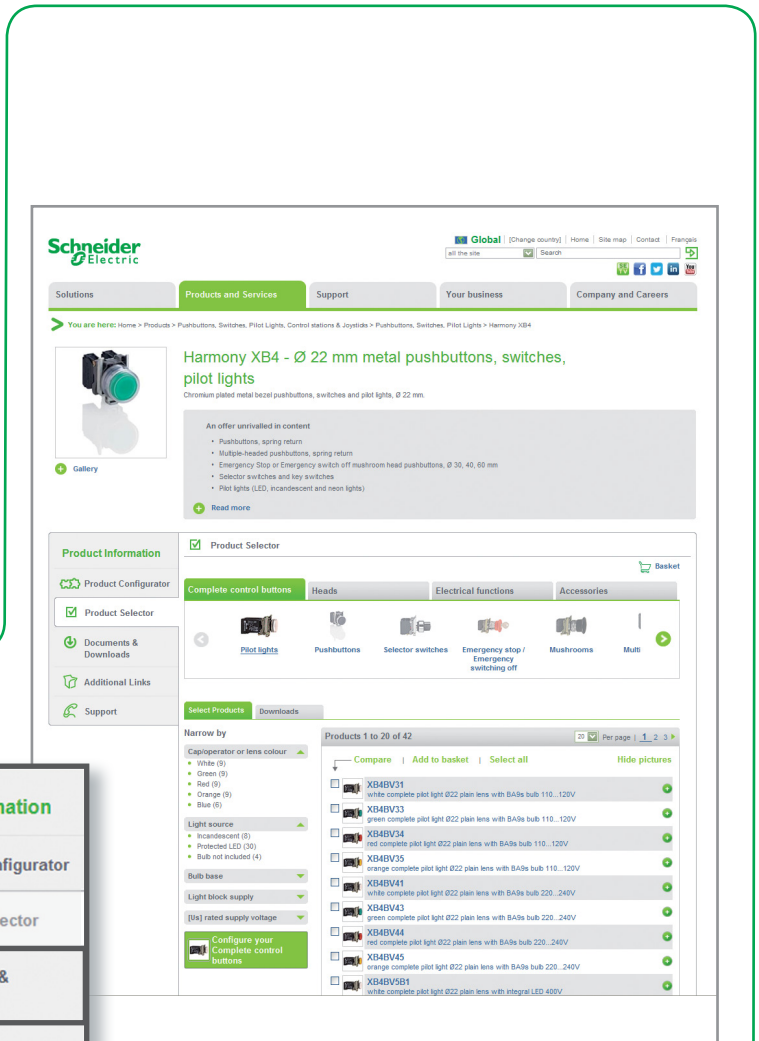

Dynamic catalogs (hyperlinks, video, ...)



Product selector: dynamic filters to get easily your part number

Access product references with adapted tools



Path: www.schneider-electric.com > **Products and Services** > Automation and control > ... > Product offer

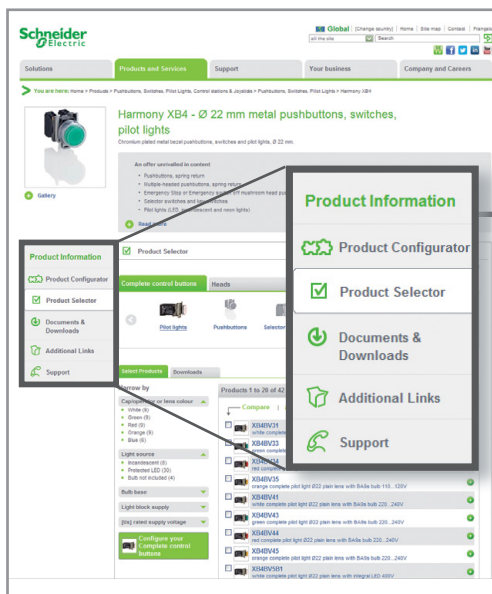

Graphic product configurator
Select the right product with just a few clicks

Dynamic product selector
Visualize product characteristics and dimensions

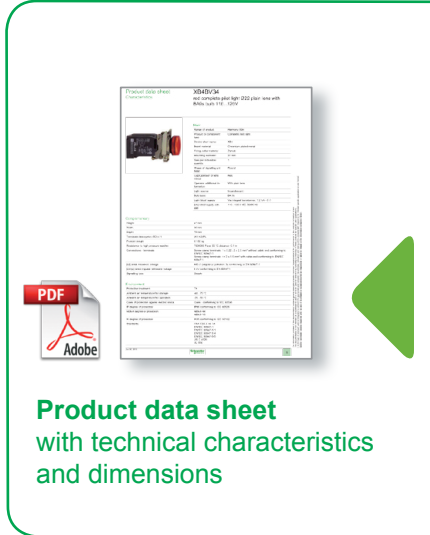
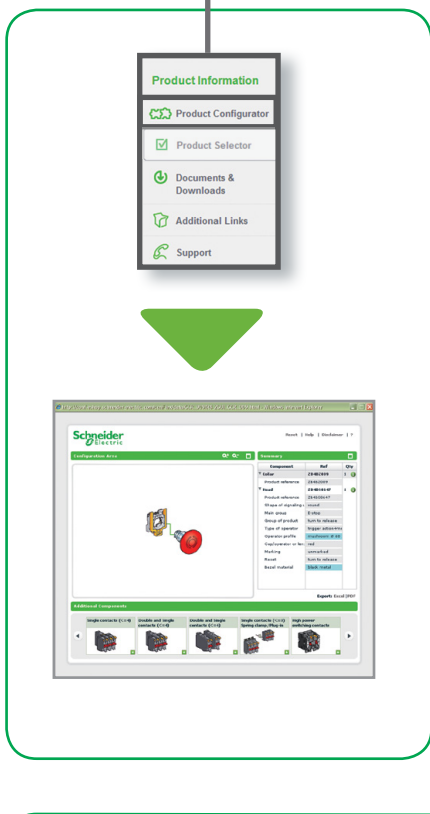

Product data sheet
with technical characteristics
and dimensions

Dimensions

Technical characteristics

Compare, select, and compile



Path: www.schneider-electric.com > **Products and Services** > Automation and control > ... > Harmony XB4*

Compare
technical
characteristics

Select
and store
your products
into
the basket

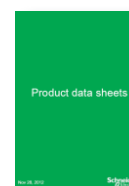

Compile
data sheets
in a unique
document

* Example of research on a product

Check the product status, design your equipment



Path: www.schneider-electric.com > **Support** > Product Substitution Tool
 Path: www.schneider-electric.com > **Support** > CAD files

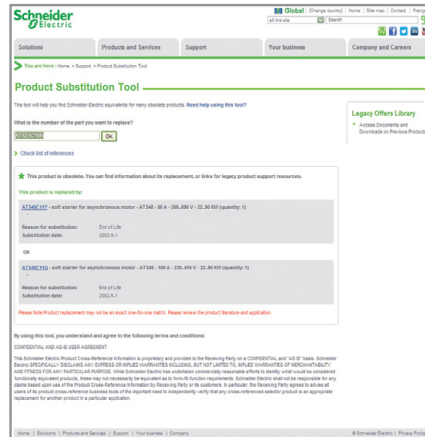
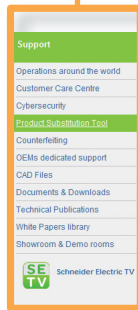
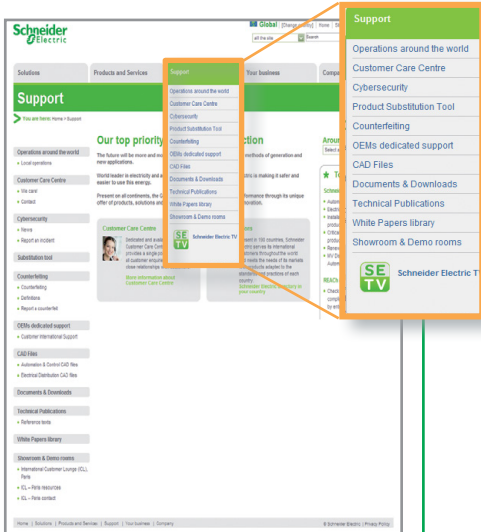

Product status:
 indicate whether the product is still commercialized. Otherwise, the tool suggests a product substitution.

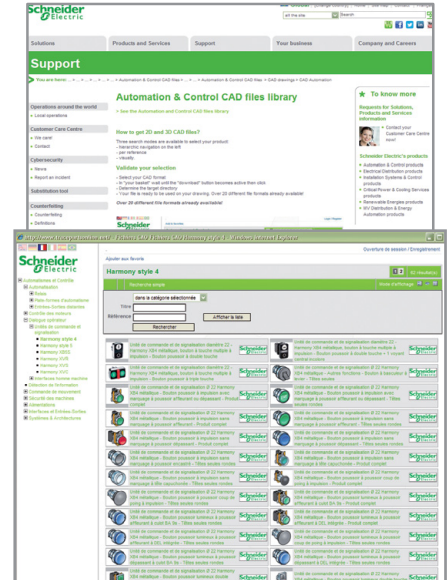

CAD files:
 available in various formats they will be easily integrated into your installation design software.

Please note that references to products and services are just examples.

X	
XVS10BMW	7
XVS10GMW	7
XVS10MMW	7
XVS14BMW	7
XVS14GMW	7
XVS14MMW	7
XVS72BMBN	7
XVS72BMBP	7
XVS72BMWN	7
XVS72BMWP	7
XVS96BMBN	7
XVS96BMBP	7
XVS96BMWN	7
XVS96BMWP	7

Schneider Electric Industries SAS

Head Office
35, rue Joseph Monier
F-92500 Rueil-Malmaison
France

www.schneider-electric.com

The information provided in this documentation contains general descriptions and/or technical characteristics of the performance of the products contained herein. This documentation is not intended as a substitute for and is not to be used for determining suitability or reliability of these products for specific user applications. It is the duty of any such user or integrator to perform the appropriate and complete risk analysis, evaluation and testing of the products with respect to the relevant specific application or use thereof. Neither Schneider Electric nor any of its affiliates or subsidiaries shall be responsible or liable for misuse of the information contained herein.

Design: Schneider Electric
Photos: Schneider Electric
Printed by:

DIA5ED2130804EN

September 2013